



1Z0-1071-20^{Q&As}

Oracle Cloud Platform Digital Assistant 2020 Specialist

Pass Oracle 1Z0-1071-20 Exam with 100% Guarantee

Free Download Real Questions & Answers **PDF** and **VCE** file from:

<https://www.geekcert.com/1z0-1071-20.html>

100% Passing Guarantee
100% Money Back Assurance

Following Questions and Answers are all new published by Oracle
Official Exam Center

- ⚙️ **Instant Download** After Purchase
- ⚙️ **100% Money Back** Guarantee
- ⚙️ **365 Days** Free Update
- ⚙️ **800,000+** Satisfied Customers





QUESTION 1

To prepare the remote application launch, the System, Webview component calls an intermediary service that prepare the remote web application call. The code snippet is given below:

```
callWebview:
  component: "System.Webview"
  properties:
    service: "oracletravelweb"
    sourceVariableList: "origin,destination"
    variable: "webviewresponse"
    prompt: "Press 'Open Oracle Travel' to complete your reservation"
    linkLabel: "Open Oracle Travel"
    cancelLabel: "Cancel"
  transitions:
    next: "evaluateWebviewResponse"
  actions:
    textReceived: "onCancel"
    cancel: "onCancel"
```

At run time, the system.Webview component sends the intermediary service a POST request. Which three options are true for the POST payload generated based on the code?

- A. Bot designer is responsible to manually add the webview.onDone parameter to the payload.
- B. The key names match the name of the dialog flow variables configured in the "sourceVariableList" property of the system.webview component.
- C. The webview.onDone parameter is automatically added to the payload and it passes the skill's callback URL property to the web application.
- D. The POST payload is a JSON object that contains an array of key-value pairs.
- E. There is no such webview.onDone property passed to the payload.

Correct Answer: ACD

QUESTION 2

Error handlers can be defined in different locations with different scopes Which statement is FALSE regarding the placement of error handlers?

- A. An error handler can be defined globally for a skill using the defaultTransition error transition.
- B. An error handler can be defined as a transition on any dialog flow state in a skill.
- C. The system error handler is called in case of an error when no error handling is defined on the current dialog flow state or as a default transition.
- D. You can define a system-wide custom error handler on the digital assistant level.

Correct Answer: A

**QUESTION 3**

What happens after the skill output Welcome to our store's chat bot! in this dialog flow?

```
output1:
  component: "System.Output"
  properties:
    text: "Welcome to our store's chat bot!"
  keepTurn: true
  transitions:
    next: "output2"

output2:
  component: "System.Output"
  properties:
    text: "You can ask me about what products we have in the store."
  transitions:
    next: "intent"
```

- A. The skill displays "Welcome to our store's chat bot!" again.
- B. The skill goes to output2, outputs "You can ask me about what products we have in the store", and then returns control to the user.
- C. The skill returns control to the user. After the user enters text, it goes to the intent state.
- D. The skill returns control to the user. After the user enters text, it goes to output2 and outputs "You can ask me about what products we have in the store."

Correct Answer: A

QUESTION 4

View the Exhibit.

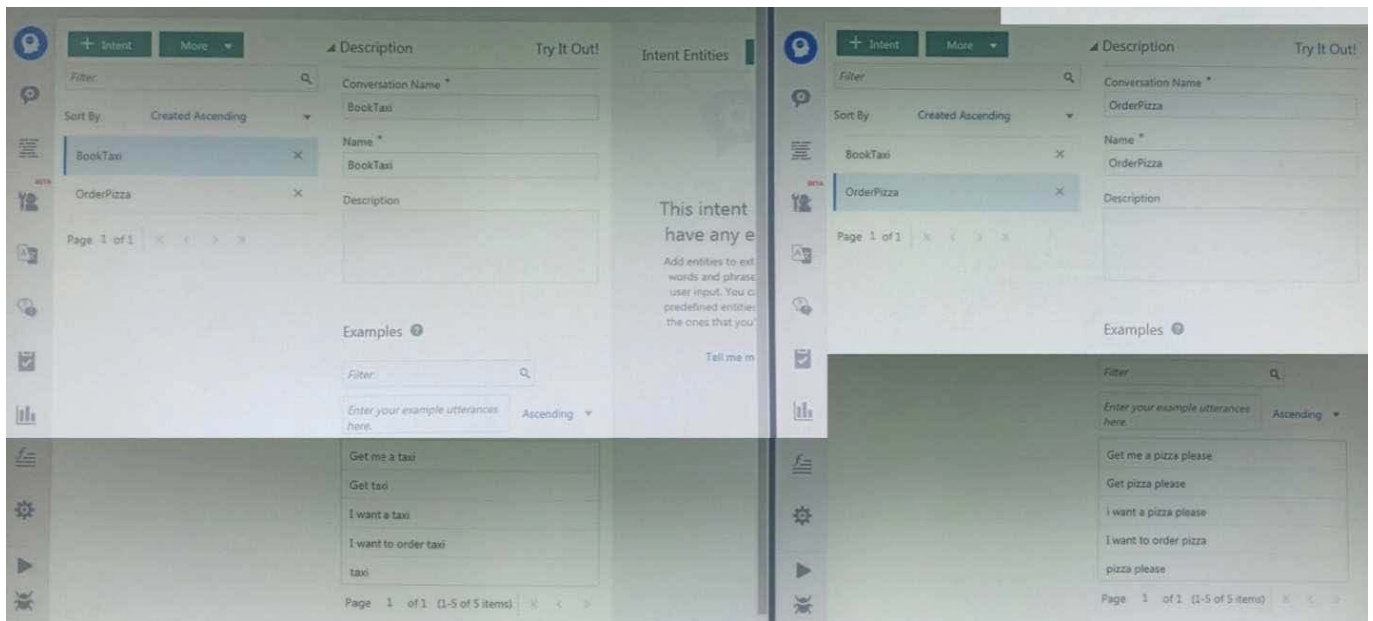

You have been asked to review a skill for its readiness for go live. Which four issues would you raise as a priority?

- A. The unresolvedIntent has not been trained.
- B. The utterances have too much commonality.
- C. All utterances should start with an uppercase letter and end with a period.
- D. The word "please" may inadvertently skew the results.
- E. You should never have single-word utterances.
- F. The number of utterances looks to be too low and artificial for a go-live.

Correct Answer: ABDF

QUESTION 5

You are building a skill for ordering pizza and you need it to determine when a user enters the pizza toppings and pizza size in their request.

Which Oracle Digital Assistant feature would you use to identify these variable values in a user's message?

- A. entities
- B. answer intents
- C. channels
- D. digital assistants



VCE & PDF

GeekCert.com

<https://www.geekcert.com/1z0-1071-20.html>

2024 Latest geekcert 1Z0-1071-20 PDF and VCE dumps Download

Correct Answer: A

[Latest 1Z0-1071-20 Dumps](#)

[1Z0-1071-20 Practice Test](#)

[1Z0-1071-20 Exam
Questions](#)